

SAGE LIVING HOME & DÉCOR PRIVATE LTD

SPINDEL CHANDELIER

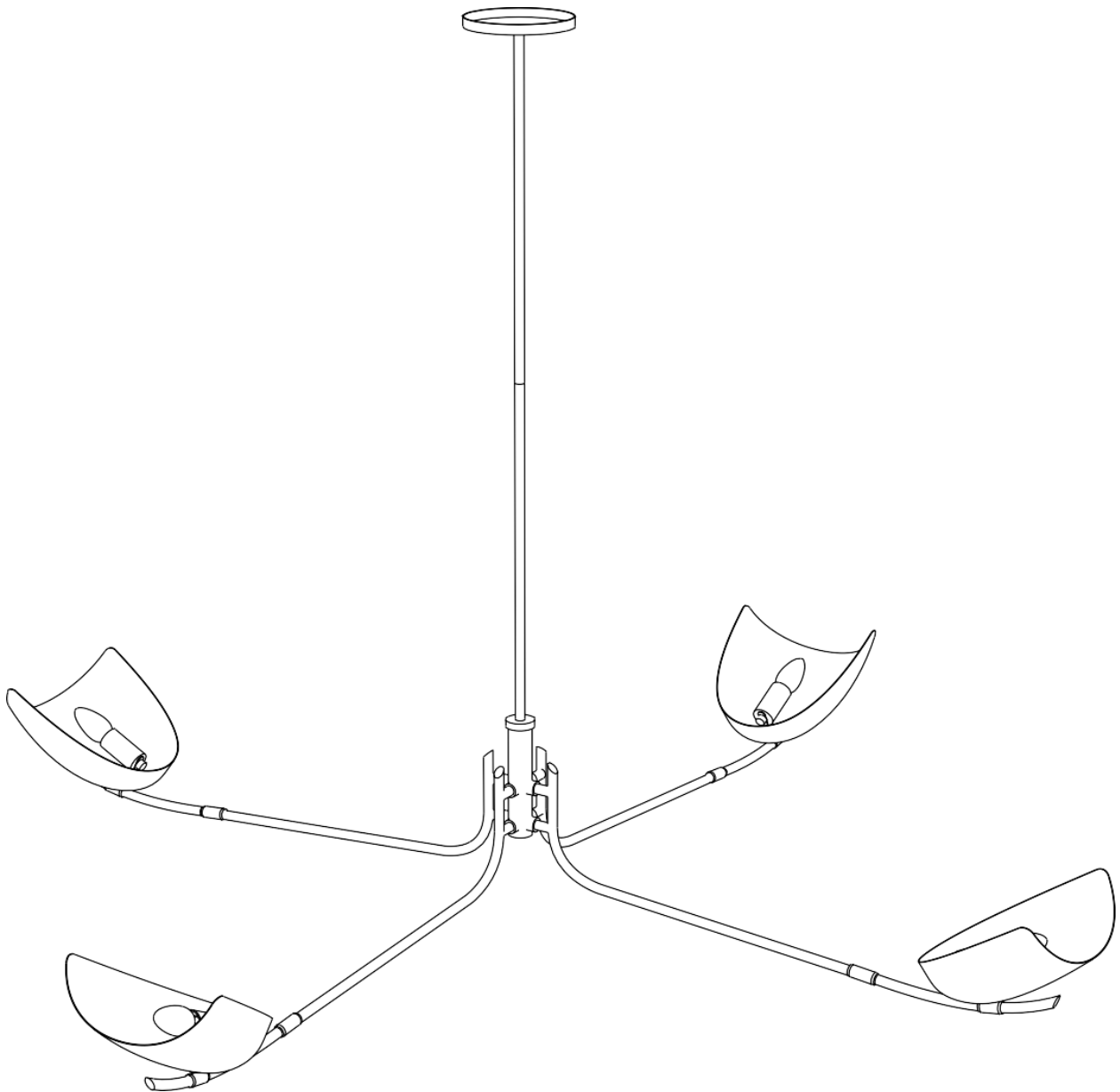

ASSEMBLY INSTRUCTIONS

- This product requires 4, type B E14 bulbs, maximum wattage limit being 40 WATT. Bulbs are not provided.
- Do not dispose of any packaging or contents of the shipping carton until assembly is completed to avoid any accidentally discarding small parts or hardware.
- Keep the parts on a carpet/ bubble wrap/ soft cloth while assembling to avoid scratches.
- Kindly keep any sharp surfaces or objects away from the assembly area such that they do not scratch or damage the product.
- Assemble in a clean area.
- Kindly use gloves while assembling.
- All wires are connected. When unpacking, be careful not to pull wires, as a bad connection may result.
- Shut off the power to the main electric circuit supply before beginning work. Lockout the circuit or the panel so the power can not be turned on while you are working. If handled improperly, electricity poses personal injury and fire hazards.
- Always turn off the fixture and allow it to cool before replacing the light bulb.
- Do not touch or look directly at the bulb when the fixture is illuminated.
- Keep flammable materials away from the lit bulb.

PARTS INCLUDED:

No.	Item
1	Crossbar
2	Mounting Screw
3	Fixture Assembly
4	Canopy
5	Ground Screw
6	Wire Nut
7	Brass Nut
8	Set Screw
9	Allen Key
10	Bulb
11	Extension Pipe X 2

TOOLS NEEDED



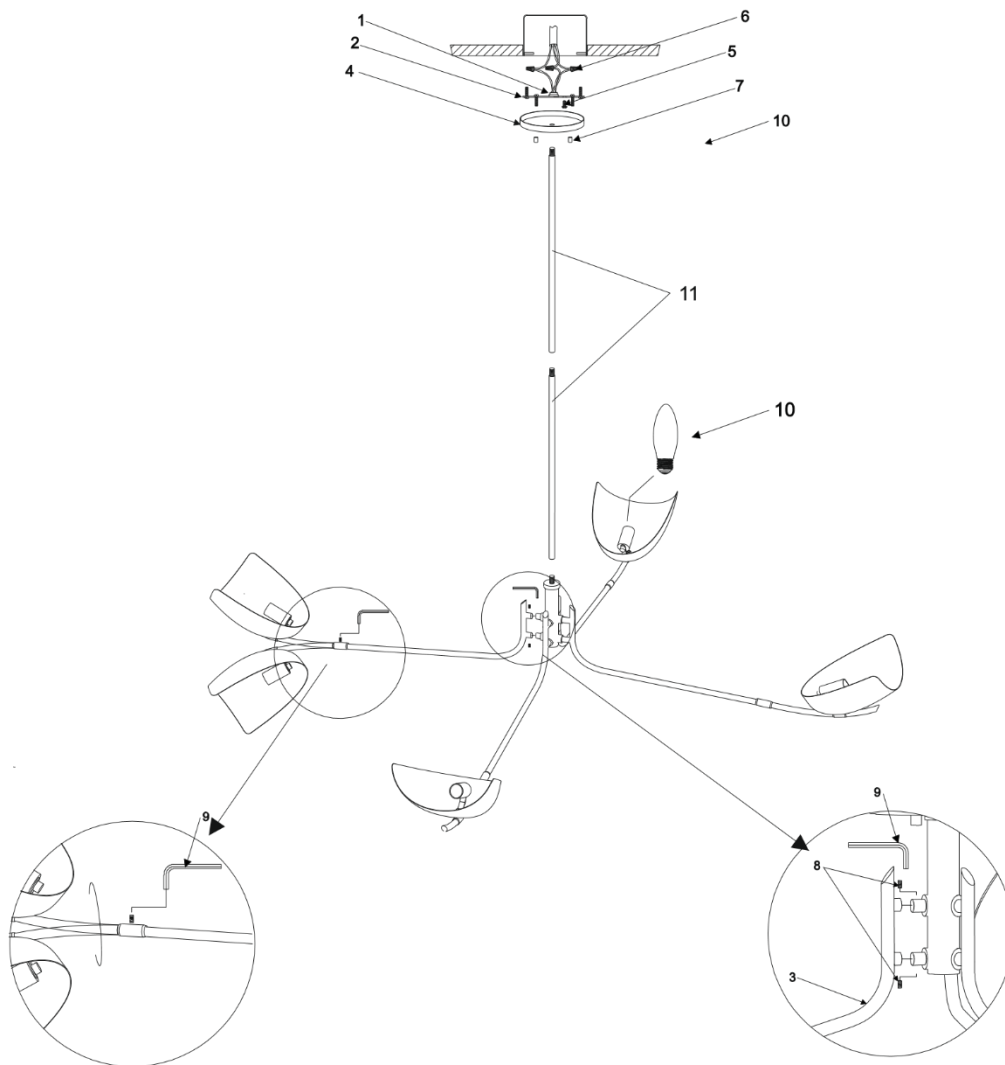

STEP:-1 Attach the Crossbar(1) unto the junction box using the Mounting Screws(2). This fixture is designed to be mounted on standard round or octagon junction box. The junction box must be securely mounted to the structure of the building.

STEP:-2 Attach the arms to the Fixture Assembly(3) and secure using the Set Screws(8) and Allen Key(9).

STEP:-3 Cut off excess wire, and strip the insulation off the end of the leads.

STEP:-4 Attach the Ground wire (Green) to the ground inside the outlet box (Generally green or bar copper wire) or the Ground Screw(5) on the Mounting Plate (1). **NEVER CONNECT GROUNDWIRE TO “HOT” WIRE. FAILURE TO FOLLOW THIS COULD RESULT IN SERIOUS INJURY OR DEATH.**

STEP:-5 Connect the white fixture lead to the neutral (Generally white) wire in the outlet box. Fasten the wires together with an approved fastener (Wire Nut)(6). Starting 1” below the fastener, tightly wrap the connection with electrical tape so that the connections seal the end of the fastner. **MAKE SURE THERE ARE NO EXPOSED WIRE OF STRANDS THAT COULD CAUSE A DANGEROUS SHORT CIRCUIT.**

STEP:-6 Connect the black fixture leads to the hot (Generally black) wire in the junction box. Fasten the joined wires same as previous step. **NEVER REVERSE HOT AND NEUTRAL WIRES. FAILURE TO FOLLOW THIS COULD RESULT IN SERIOUS INJURY OR DEATH.**

STEP:-7 Push the wires back into the junction box. Lift up the Fixture(3) up to the ceiling and screw the Canopy(4) with the Brass Nuts(7).

STEP:-8 If height extension is required, attach the Pipes(11) as shown in the image.

STEP:-9 Screw the Bulb (10) up into the socket of the fixture. **THIS FIXTURE IS RATED FOR 40 WATT TYPE B LAMP. DO NOT EXCEED THE RECOMMENDED WATTAGE.**

STEP:-10 Restore power to the outlet at the breaker or fuse box.

PRODUCT DETAILS

- *Dimensions: W 66” x D 66” x H 47”; Weight: 5.5 kg. Height without extendable pipes 10.5”
- *Brass frame structure finished in Antique Brass and Black PC.
- *Rated for interior usage only.
- *There may be slight variations in color and/or craftsmanship which make each piece of handmade product unique and are not product defects.
- *All handmade products are handcrafted one at a time. It is therefore rare to create identical items. Every piece is a creation of artisans.

CARE INSTRUCTIONS

- * Dust often using a clean, soft, dry and lint-free cloth.
- * Wipe spills immediately with a clean, damp cloth.
- * Do not use harsh or abrasive chemicals, furniture polish, or any surface cleaners on the products.

NOTE: Sage Living will not cover for any damages that occur during installation.